



Park Forest Public Library
also serving Olympia Fields

400 Lakewood Blvd., Park Forest, IL 60466
708-748-3731; www.pfpl.org

Sunday (Sep.-May): 1:00pm – 5:00pm
Monday-Thursday: 10:00am – 9:00pm
Friday & Saturday: 10:00am – 5:00pm

HOTSPOT SETUP GUIDE

Connecting Your Devices:

1. Turn on the hotspot. Charge the hotspot if needed. A power cable and a power adapter have been provided.
2. The Wi-Fi name taped on the hotspot should appear in your device's Wi-Fi settings.
3. Enter the password taped on the hotspot to connect.

Charging the Battery:

Follow these instructions to charge your hotspot's battery using either the included AC adapter or via a USB connection on your computer.

Charging Conditions: Under low temperatures charging performance decreases. Charge in temperatures between 0 and 55 degrees Celsius. Do not charge in places where there is high humidity. USB charging may be unavailable depending on hotspot temperature.

Use Supplied Accessories: Always use the supplied AC adapter or micro USB cable.

Precaution for Extended Use: Your device may become hot when used for a long time or while charging, especially in high temperatures. Prolonged contact with skin may cause low-temperature burns.

ZTE Warp Connect and AC Adapter Becoming Warm or Hot

Your hotspot and the AC adapter may become warm while charging. This is not a malfunction. However, stop using them immediately if they become extremely hot; this could indicate a malfunction.

Charge Using the AC Adapter:

Follow these instructions to charge your hotspot using the included AC adapter:

1. Plug the USB connector into the charging/micro-USB jack on the bottom of your hotspot.

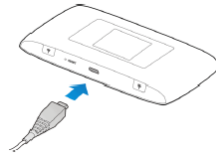

2. Plug the other end of the USB cable into the AC adapter.
3. Plug the AC adapter into an electrical outlet.

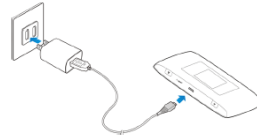

4. After charging, disconnect the hotspot from the charger.

Charge Using the AC Adapter:

Before using a PC connection to charge your hotspot, ensure that the computer is turned on.

1. Insert the small end of the USB cord into the charging/micro-USB jack on the bottom of your hotspot.

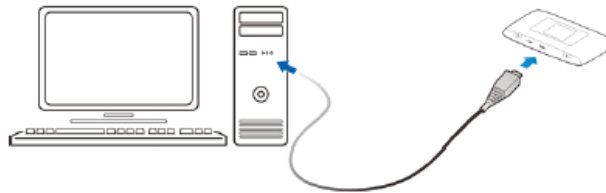

2. Insert the large end of the USB cord into an external USB port on your computer.
3. After charging, remove the USB cable from both the hotspot and the computer.

ZTE Warp Connect and AC Adapter Becoming Warm or Hot

Your hotspot and the AC adapter may become warm while charging. This is not a malfunction. However, stop using them immediately if they become extremely hot; this could indicate a malfunction.